

harmony[®]

DREAMTIME ELITE CAR SEAT INSTRUCTION MANUAL

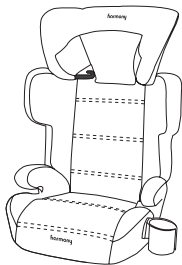

This booster seat complies with ECE regulations for use by children:

- Group II / III
- Mass: 15 to 36 kg

For children approx. 4 years to 12 years

READ THIS MANUAL

Do not install or use this booster seat until you read and understand the instructions in this manual and in your vehicle owner's manual.

FAILURE TO PROPERLY USE THIS BOOSTER SEAT INCREASES THE RISK OF SERIOUS INJURY OR DEATH IN A SHARP TURN, SUDDEN STOP OR CRASH.



IF YOU HAVE ANY PROBLEMS, PLEASE DO NOT RETURN THIS PRODUCT TO THE PLACE OF PURCHASE. PLEASE CONTACT CUSTOMER SERVICE AT +44 (0) 1704 549881 OR AT WWW.HARMONYJUVENILE.COM

REGISTRATION INFORMATION

REGISTER YOUR BOOSTER SEAT TODAY! Child restraints could be recalled for safety reasons. You must register this restraint to be reached in a recall, and to be eligible to receive replacement parts while under warranty.

The model number, serial number and manufacturing date can be found on a label on the underside of the booster seat.

Visit www.harmonyjuvenile.com/uk/register to register your child restraint online, mail-in the registration card or send your name, address, the restraint's model number, manufacturing date and date of purchase to:

**Harmony Juvenile Products UK
10 Beach Priory Gdns.
Southport, UK
PR8 1RT
or call: +44 (0) 1704 549881**

For recall information, any questions you may have, or to make a change of address or contact information please call Customer Service at +44 (0) 1704 549881 or visit us online at **www.harmonyjuvenile.com**.

**PLEASE DO NOT SEND IN YOUR REGISTRATION CARD IF
YOU HAVE REGISTERED YOUR RESTRAINT ONLINE.**

IF YOU NEED HELP

Please fill in the information below for future reference. The model number and manufacturing date can be found on a label on the underside of the booster seat.

Model Number: _____

Manufacture Date: _____

Date of Purchase: _____

Our Customer Service Department is standing by to help you with any questions or concerns you may have regarding installation, use, care and/or parts. Please have your product's model number and manufacturing date available when contacting us.

PARTS LIST

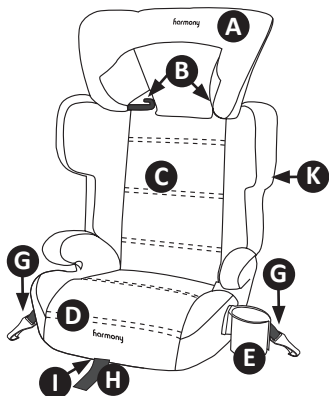

- A** Headrest
- B** Shoulder belt positioning guides
- C** Backrest
- D** Base
- E** Cup holder (when applicable)
- F** Headrest Height Adjuster (red handle behind headrest)
- G** LATCH system
- H** Up-front LATCH adjustment belt
- I** LATCH release button (under base)
- J** Shoulder belt guide (not installed)
- K** Instruction manual storage

Pre-installed: Fabric seat covers and EPE foam.

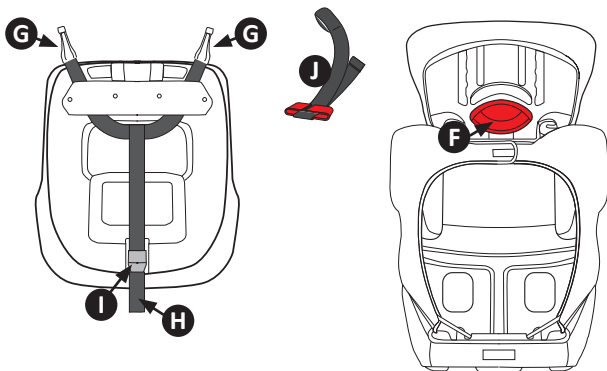

TO PURCHASE REPLACEMENT PARTS:

In the United Kingdom, please contact us at
www.harmonyjuvenile.com
 or by calling +44 (0) 1704 549881.

ASSEMBLING/DISASSEMBLING BACKREST

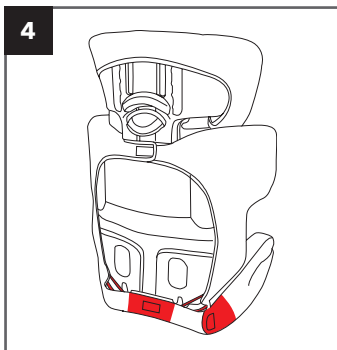
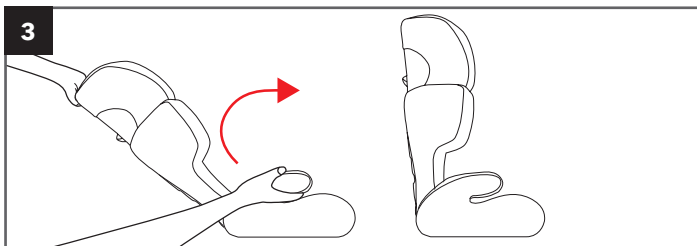
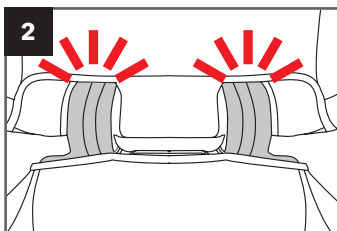
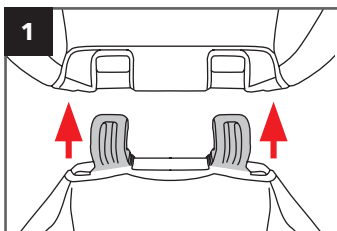

HEADREST HEIGHT ADJUSTMENT

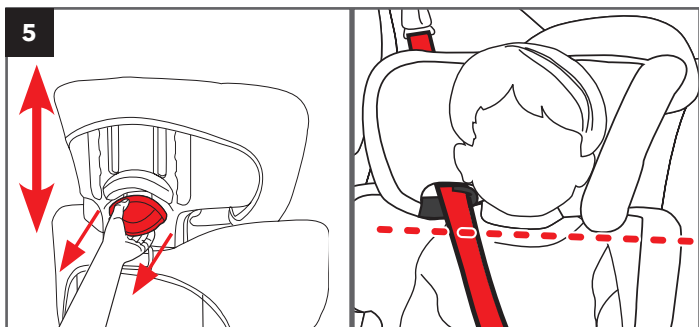

INSTALLING WITH LATCH SYSTEM

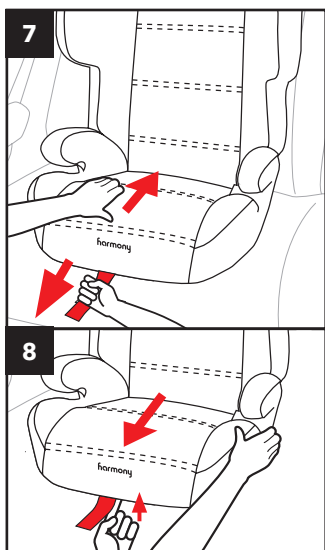
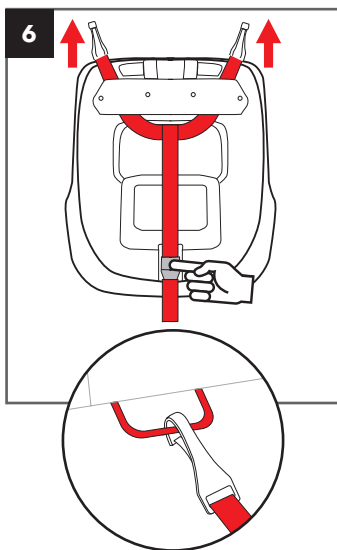

INSTALLING WITH VEHICLE SEAT BELT

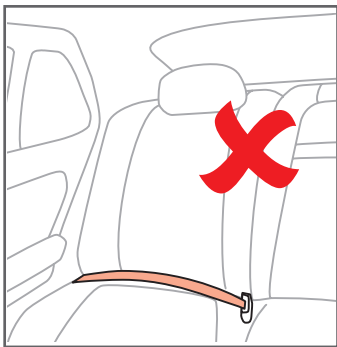
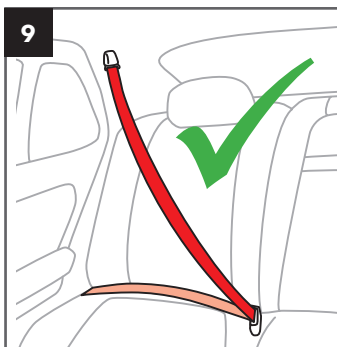

SECURING CHILD AND BOOSTER SEAT IN VEHICLE



INSTALLATION WITH BACKREST

GROUP 2 & 3 (15 - 36 KG)

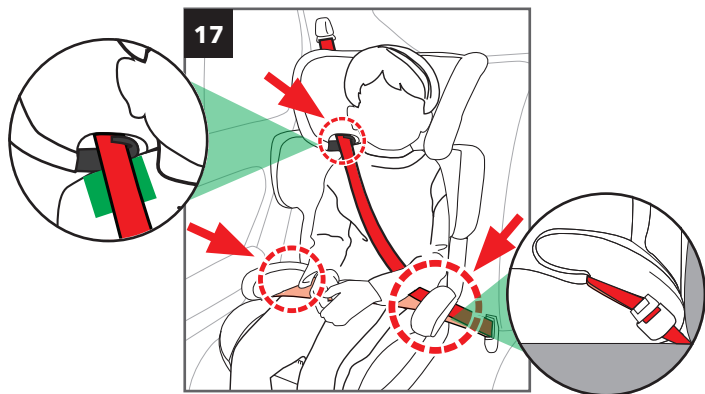

INSTALLATION WITHOUT BACKREST

GROUP 3 (22 - 36 KG)

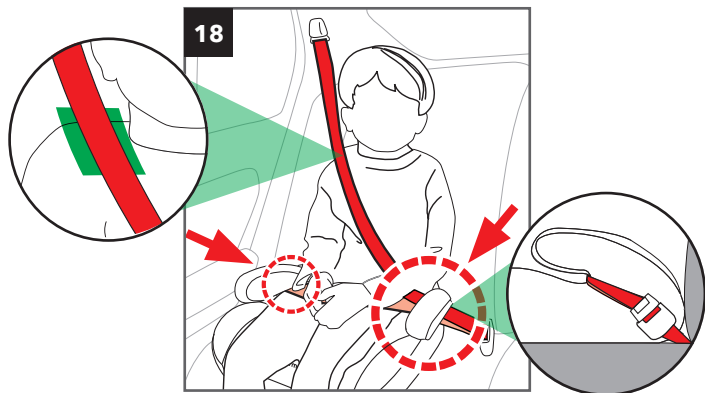

INSTALLING/REMOVING SHOULDER BELT GUIDE

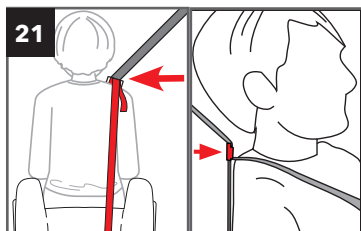
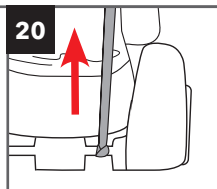
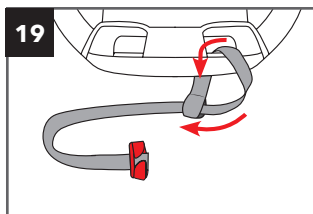

INSTALLING CUP HOLDER (WHEN APPLICABLE)

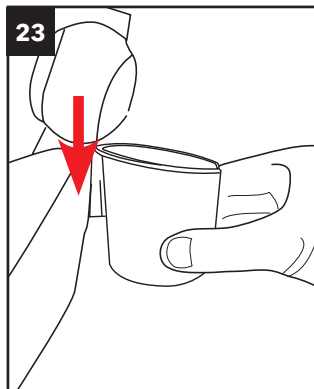
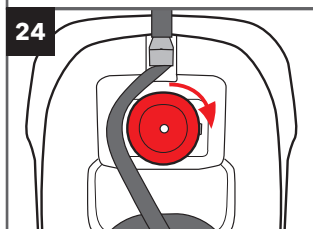
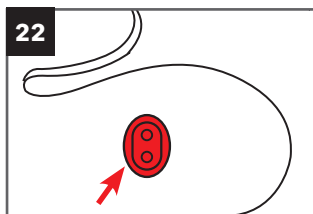

REMOVING/INSTALLING FABRIC SEAT COVER

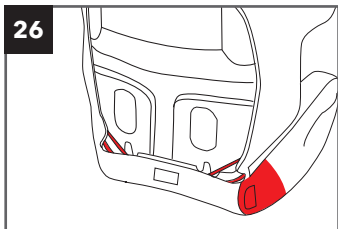
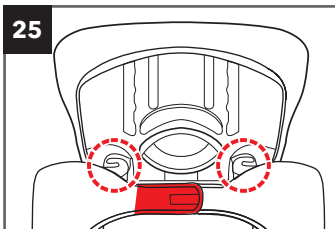

CERTIFICATIONS

This is a "Universal" child restraint when installed using the 3-point vehicle seat belt only. It is approved to the requirements of the European Standard for Child Safety Seat Equipment under Regulation No. 44, 04 series of amendments, for general use in vehicles and it will fit most, but not all, car seats.

A correct fit is likely if the vehicle manufacturer has declared in the vehicle handbook that the vehicle is capable of accepting a "Universal" child restraint for this age group.

This child restraint has been classified as "Universal" under more stringent conditions than those which applied to earlier designs which do not carry this notice.

If in doubt, consult either the child restraint manufacturer or the retailer.

! Only suitable for use in the listed vehicles fitted with 3-point with retractor safety-belts, approved to ECE Regulation No. 16 or other equivalent standards.

This restraint is **NOT CERTIFIED** for aircraft use.

This child restraint must **NOT** be used in homes, boats, buses, motorcycles, motor homes, or any other vehicles that have non-forward-facing seats, missing seat belts, or whose seat belts do not meet the requirements of this child restraint.

ASSEMBLING/DISASSEMBLING BACKREST

1. Insert 'U-Shape' plastic hooks on bottom of backrest into the corresponding bars on seat base **(1)**. Apply a small amount of force to gently lock the hooks onto base **(2)**.
2. While holding fabric down at rear of seat base, slowly swing the backrest upwards, whereby locking the backrest into place **(3)**. The hook-and-loop portion of the fabric at rear of seat should be **UNDER** the backrest **(4)**.
3. Secure fabric **(4)**.
4. To remove backrest, repeat previous steps in reverse order.

PREPARING BOOSTER SEAT FOR USE



WARNING!

INCORRECT USE OF THE VEHICLE'S 3-POINT LAP-AND-SHOULDER SEAT BELT SYSTEM IS THE MOST COMMON MISTAKE PEOPLE MAKE. IT IS VERY IMPORTANT TO READ, UNDERSTAND AND FOLLOW ALL INSTRUCTIONS AND WARNINGS. DO NOT MISTAKE COMFORT FOR SAFETY. THE VEHICLE'S 3-POINT LAP-AND-SHOULDER SEAT BELT MUST BE SNUGLY ADJUSTED AT ALL TIMES.

! ENSURE the vehicle shoulder belt's position is correct for your child's size. **VERIFY OFTEN.**

! WARNING: DO NOT use this booster seat if the midpoint of your child's head is above the top of the booster seat headrest at its maximum height.

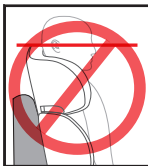

HEADREST HEIGHT ADJUSTMENT

Your booster seat has six (6) height adjustments.

Adjust headrest height so that the bottom of the headrest is **EVEN** with or **JUST ABOVE** the top of the child's shoulders **(5)**.

- Pull the Headrest Height Adjuster to raise/lower headrest to desired height.

WARNING!

- ! **ALWAYS** ASSIST YOUR CHILD WHEN GETTING INTO AND OUT OF YOUR CHILD RESTRAINT/BOOSTER SEAT.
- ! **NEVER** LET YOUR CHILD LEAN ON THE ARMREST WHEN GETTING INTO OR EXITING THE BOOSTER SEAT TO PREVENT THE SEAT FROM TIPPING.
- ! **ENSURE** THAT THE BOOSTER SEAT IS LEVEL, STABLE AND DOES NOT ROCK SIDE-TO-SIDE. IF THE BOOSTER SEAT IS NOT STABLE, TRY ANOTHER SEATING LOCATION. IN VEHICLES WITH WIDE, FLAT SEATS, A ROLLED TOWEL CAN BE USED ON THE OUTBOARD (DOOR) SIDE TO ADD STABILITY TO THE BOOSTER SEAT.
- ! **DO NOT ADD ANYTHING BEHIND OR UNDER THE BOOSTER SEAT.**

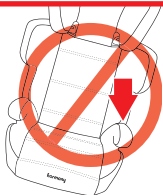

LATCH

WARNING!

USE ONLY THE VEHICLE'S 3-POINT LAP-AND-SHOULDER BELT SYSTEM WHEN RESTRAINING THE CHILD IN THIS BOOSTER SEAT.

LATCH can be used to secure the booster seat to the vehicle.

LATCH can **ONLY** be used if your vehicle has the Isofix/LATCH anchors installed and designated Isofix/LATCH seating positions. Check your vehicle owner's manual to see which seating positions may be equipped with Isofix/LATCH.

If your vehicle is equipped with Isofix/LATCH, the vehicle Isofix/LATCH anchorage points may be visible at the seat crease. If not visible, they may be marked with this symbol.



Check your vehicle owner's manual for your vehicle's exact Isofix/LATCH locations, anchor identifications and usage requirements for use with a booster seat.

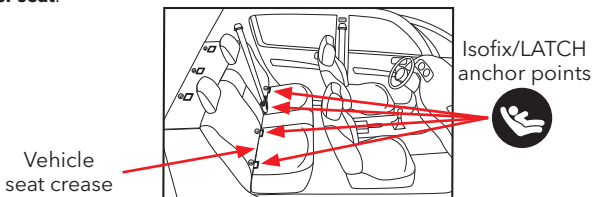

INSTALLING WITH LATCH SYSTEM



WARNING!

INSTALLING THIS BOOSTER SEAT USING LATCH DOES NOT SECURE THE CHILD. THE VEHICLE'S 3-POINT LAP-AND-SHOULDER BELT MUST BE USED TO SECURE THE CHILD IN THE BOOSTER SEAT.

1. Loosen LATCH by pressing upwards on the LATCH release button found directly under the up-front adjuster strap while sliding the LATCH clips out from storage area **(6)**. For ease of installation, extend LATCH to its maximum length. Ensure the LATCH straps are **NOT** twisted and that the LATCH connectors are facing down.
2. Place the booster seat flush against a forward-facing vehicle seat, **CENTERED** between the LATCH anchors.
- ! WARNING:** When using LATCH, **DO NOT** place the child restraint off-center of the vehicle anchors.
3. Fasten LATCH hooks to vehicle LATCH anchors ensuring the hooks are facing downwards **(6)**. Pull firmly to be sure that they are attached. Belts must lay flat and not be twisted.
4. Tighten LATCH by pulling on the upfront LATCH adjustment belt while pushing the child restraint towards the vehicle backrest **(7)**.
5. To loosen the LATCH, press upwards on the LATCH release button and pull child restraint forward **(8)**.

! WARNING: **NEVER** put two connectors on one vehicle Isofix/LATCH anchor **(A)**.

! WARNING: **DO NOT** secure the booster seat to the vehicle's Isofix/LATCH anchors if the seat belt or seat belt buckle is not easily accessible once the booster seat is latched in place.

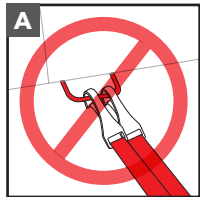

INSTALLING WITH VEHICLE SEAT BELT

! WARNING: You **MUST** use the vehicle 3-point lap-and-shoulder belt when restraining the child in the booster seat **(9)**. LATCH **WILL NOT** secure your child in the booster seat.

SECURING CHILD AND BOOSTER SEAT IN VEHICLE



WARNING!

FAILURE TO PROPERLY SECURE YOUR CHILD IN THE BOOSTER SEAT INCREASES THE RISK OF SERIOUS INJURY OR DEATH IN THE EVENT OF A SHARP TURN, SUDDEN STOP OR CRASH. In a crash, the booster seat provides **NO** protection for your child unless the vehicle 3-point lap-and-shoulder belt is properly secured. Follow these instructions carefully to properly secure your child.

! DO NOT use this booster seat if it can't be properly leveled, stabilized, and installed as per this instruction manual. It is possible that your vehicle has no suitable seating position for this booster seat due to seating surface, seat belt type and/or airbag system. Read and follow these instructions, and your vehicle owner's manual carefully.

! WARNING: Vehicle belts **MUST** be tight, adjusted to the child's body, and should not be twisted **(10)**.

! NEVER use a vehicle lap-only belt to secure child in booster seat **(11)**.

! NEVER USE A LOOSE SHOULDER BELT.

! NEVER position the shoulder belt under the child's arm **(12)** or place the shoulder belt behind the child's back **(13)**.

! Lap portion of lap-and-shoulder belt MUST be low and snug across the hips, with the pelvis firmly engaged, just touching the child's thighs. The lap portion **MUST NOT** be lying across the child's stomach as this can cause major injuries to the child in case of a sharp turn, sudden stop or crash.

! DO NOT allow the child to slouch, slide down in the seat, or create slack in the belt system **(14)**. If child will not keep vehicle belt properly positioned, **DO NOT** use this booster seat.

! DO NOT position vehicle belt over top of the armrests **(15)**.

! The vehicle seat headrest should not create a gap between vehicle seat and booster seat (16). If so, remove the vehicle headrest.

! DO NOT use any load bearing contact points other than those described in the instructions and marked in the child restraint.

IF IN DOUBT ABOUT THESE POINTS OR ANY QUESTIONS RELATED TO INSTALLATION, PLEASE CONTACT HARMONY JUVENILE PRODUCTS.

INSTALLATION WITH BACKREST

GROUP 2 & 3 (15 - 36 KG)



WARNING!

DUE TO VARYING ANGLES OF VEHICLE SEAT BELT RETRACTORS, EXCESS SLACK IN THE VEHICLE BELT SYSTEM MIGHT NOT BE REMOVED AUTOMATICALLY. Once the lap and shoulder portions of the seat belt are properly positioned and the buckle is attached, **FEED ANY REMAINING SLACK OF THE SEAT BELT MANUALLY BACK INTO THE RETRACTOR TO TIGHTEN THE WHOLE SYSTEM.**

1. Place the booster seat flush against a forward-facing vehicle seat. The vehicle seat **MUST** be equipped with a 3-point lap-and-shoulder belt. Booster must be level, stable and not rock side-to-side.
2. Place child in the booster seat with child's back flat against the back of the booster seat.
3. Adjust headrest height so that the bottom of the headrest is **EVEN** with the top of the child's shoulders. See section "Headrest height adjustment".
4. Thread shoulder belt portion of the 3-point lap-and-shoulder belt system through the shoulder belt guide and ensure that shoulder belt lies across child's shoulder and chest, and **NOT** across child's face or neck.
5. **Thread both sides of the lap belt under BOTH armrests. Thread the lower end of the shoulder belt UNDER the armrest on the buckle side (17). ENSURE that the belt is snug across the child's hips. It is important to ensure that any lap strap is worn low down, so that the pelvis is firmly engaged, just touching their thighs and is NOT across their stomach.**
6. Buckle the vehicle seat belt into place and ensure it is secure by gently pulling on it.

! BOTH SIDES OF THE LAP BELT MUST PASS UNDER BOTH ARMRESTS, AND THE LOWER END OF THE SHOULDER BELT MUST PASS UNDER THE ARMREST ON THE BUCKLE SIDE.

! Any straps holding the restraint to the vehicle should be tight, any straps restraining the child should be adjusted to the child's body, and all straps should not be twisted.

! NEVER USE A VEHICLE LAP-ONLY BELT WHEN USING THIS BOOSTER SEAT.

INSTALLATION WITHOUT BACKREST

GROUP 3 (22 - 36 KG)

! FOR CHILDREN 22 - 36 KG AND 125 CM AND TALLER.

See "Assembling/disassembling backrest" for instructions for removing the backrest.

1. Place the booster seat flush against a forward-facing vehicle seat. The vehicle seat **MUST** be equipped with a 3-point lap-and-shoulder belt. Booster must be level, stable and not rock side-to-side.
2. Place child on the booster seat with child's back flat against the vehicle seat.
3. **Thread both sides of the lap belt under BOTH armrests. Thread the lower end of the shoulder belt UNDER the armrest on the buckle side (18). ENSURE that the belt is snug across the child's hips. It is important to ensure that any lap strap is worn low down, so that the pelvis is firmly engaged, just touching their thighs and is NOT across their stomach.**
4. Buckle vehicle seat belt into place. Ensure the buckle is secure by gently pulling on it.

! BOTH SIDES OF THE LAP BELT MUST PASS UNDER BOTH ARMRESTS, AND THE LOWER END OF THE SHOULDER BELT MUST PASS UNDER THE ARMREST ON THE BUCKLE SIDE.

! Any straps holding the restraint to the vehicle should be tight, any straps restraining the child should be adjusted to the child's body, and the straps should not be twisted.

! NEVER USE A VEHICLE LAP-ONLY BELT WHEN USING THIS BOOSTER SEAT.

! THE VEHICLE'S SHOULDER BELT MUST LIE ACROSS THE CHILD'S SHOULDER AND LAY ACROSS THE CHEST - NOT THE FACE OR NECK. If the belt does not lie properly across the child's shoulder and chest, the **RED** shoulder belt guide ("Parts list - J") **MUST** be used to ensure proper placement (see "Using shoulder belt guide").

INSTALLING/REMOVING SHOULDER BELT GUIDE

! OPENING OF RED BELT GUIDE CLIP MUST FACE FORWARD.

TO INSTALL:

1. Insert loop end of strap around bar on rear of seat **(19)** on side **NEAREST** to the vehicle retractor.
2. Pass the red clip and strap through the loop end **(19)** and pull strap tight **(20)**.

It is recommended to store the unused shoulder belt guide along with any other parts from the booster seat for future use.

USING SHOULDER BELT GUIDE

1. Slide the vehicle's shoulder belt into the **RED** clip ensuring it is flat. Position the belt guide just above the child's shoulder **(21)**.

! THE VEHICLE'S SHOULDER BELT MUST LIE ACROSS THE CHILD'S SHOULDER.

! OPENING OF RED BELT GUIDE CLIP MUST FACE FORWARD.

INSTALLING CUP HOLDER (WHEN APPLICABLE)

TO INSTALL:

1. Slide cup holder into place over cup holder clip **(22, 23)** on either side until locked in place.

TO REMOVE:

1. Pull cup holder up and outward.

Store cup holder under booster seat for future use. Twist cup holder to ensure it is securely attached **(24)**.

REMOVING/INSTALLING FABRIC SEAT COVER

TO REMOVE:

HEADREST:

Unhook the left and right ELASTIC loops from each shoulder belt guide **(25)**.

BACKREST:

- Unfasten hook-and-loop tab on top of backrest **(25)**.
- Unhook left and right ELASTIC loops from each of the U-shaped extensions at the base of the backrest **(26)**.

BASE:

Unfasten hook-and-loop tab from side of seat **(26)**.

TO INSTALL:

To reinstall fabric covers, repeat previous steps in reverse order.

INSTRUCTION MANUAL STORAGE

We recommend that you store your instruction manual in the pocket provided on the side of the booster seat.

WARNINGS

GENERAL WARNINGS



WARNING!

The safety of your child and the effectiveness of this booster seat depend on:

1. **Selecting a suitable location** for the booster seat in your vehicle.
2. **Properly routing the vehicle seat belt.**
3. **Properly securing both your child and the booster seat in the vehicle.** Many seat belts are **NOT** safe to use with this booster seat. If in doubt about installing this booster seat, consult the vehicle owner's manual or call the Harmony Customer Service Department.



WARNING!

FAILURE TO PROPERLY READ, FOLLOW AND USE THESE INSTRUCTIONS AND THE BOOSTER SEAT LABELS INCREASES THE RISK OF SERIOUS INJURY OR DEATH IN A SHARP TURN, SUDDEN STOP OR CRASH. Your child's safety depends on the proper installation and use of this booster seat. Even if this booster seat seems easy to install and use, it is **VERY IMPORTANT** to read and understand these instructions and the vehicle owner's manual.

Follow all labels on this booster seat and in these written instructions. **DO NOT INSTALL OR USE THIS BOOSTER SEAT UNTIL YOU READ AND UNDERSTAND THE INSTRUCTIONS IN THIS MANUAL AND IN YOUR VEHICLE OWNER'S MANUAL.**

NO BOOSTER SEAT CAN GUARANTEE PROTECTION WHEN THE VEHICLE IS SERIOUSLY IMPACTED. However, when correctly installed, a booster seat will substantially improve the chances for survival and reduce the risk of serious injury in most crashes.

Carefully follow the instructions in this manual and in your vehicle owner's manual. If there is a discrepancy between the two, the vehicle owner's manual must take precedence with regards to seat belts and/or airbags.

! ADULT ASSEMBLY REQUIRED.

! USE THIS BOOSTER SEAT FORWARD-FACING ONLY.

! DO NOT USE THIS BOOSTER SEAT without properly assembling it.

! DO NOT allow children to play with this booster seat.

! NEVER leave children alone in a vehicle under any circumstance.

- ! It is recommended that children are not left in their child restraint system unattended.
- ! Set a good example by **ALWAYS** wearing your seat belt. Make it a firm rule that the vehicle does not move until everyone is buckled up. **MAKE NO EXCEPTIONS.**
- ! Harmony Juvenile Products advises against loaning or passing along a booster seat. **DO NOT USE A SECOND-HAND BOOSTER SEAT** or a booster seat whose history you do not know.
- ! When disposing a child restraint system, ensure to dispose of the unit in a way others cannot reuse it (e.g. use a dark trash bag, do not sell to a thrift shop or in a garage sale, etc.).
- ! Store the booster seat in a safe place when not in use. **DO NOT** place heavy objects on top of the booster seat while in storage.
- ! **DO NOT** remove any stickers or warnings as they contain important information.

USAGE WARNINGS

According to accident statistics, **CHILDREN ARE SAFER WHEN PROPERLY RESTRAINED IN THE REAR SEATING POSITIONS THAN IN THE FRONT SEATING POSITION.**

- ! **DO NOT** use any load bearing contact points other than those described in the instructions and marked in the booster seat.
- ! **DO NOT** allow others to install or use this booster seat unless they read and understand all the instructions and labels.
- ! **DO NOT GIVE THIS BOOSTER SEAT** to someone else without also giving them this instruction manual. Additional instruction manuals can be downloaded directly from www.harmonyjuvenile.com.
- ! To ensure proper booster seat use, keep and store this instruction manual and refer to it when necessary.
- ! **DO NOT LEAVE A BOOSTER SEAT UNSECURED IN YOUR VEHICLE.** In a collision, sharp turn or sudden stop, an unsecured booster seat can injure other occupants. Remove it or make sure that it is securely attached to the vehicle using LATCH (if available) or the vehicle's 3-point lap-and-shoulder belt, even when not in use.

INJURY WARNINGS

- ! **INJURIES MAY OCCUR EVEN IF YOU ARE NOT IN A CRASH** if the booster seat is not properly installed or if your child is not properly secured in the booster seat.
- ! The rigid items and plastic parts of a child restraint shall be so located and installed that they are not liable, during everyday use of the vehicle, to become trapped by a movable seat or in a door of the vehicle.
- ! **DO NOT** leave folding vehicle seats unlatched. In the event of a sharp turn, sudden stop or crash, a loose seat back could prevent the child restraint from protecting the child as well as it should.

! It is recommended that any luggage or other objects liable to cause injuries in the event of a collision shall be properly secured. In the event of a sharp turn, sudden stop or crash, loose objects will keep moving, potentially causing serious injuries.

! The child restraint shall not be used without the cover. It **MUST** always be used with the fabric cover provided by the manufacturer.

! The seat cover should not be replaced with any other than the one recommended by the manufacturer, because the cover constitutes an integral part of the restraint performance.

! **PARTS OF THE BOOSTER SEAT COULD BECOME HOT ENOUGH TO BURN THE CHILD IF LEFT IN THE SUN.** Contact with these parts can injure your child. **ALWAYS** touch the surface of any metal or plastic parts before putting your child in the booster seat. Cover the booster seat with a towel or blanket when the vehicle is parked in direct sunlight. **KEEP AWAY FROM SUNLIGHT, OTHERWISE IT MAY BE TOO HOT FOR THE CHILD'S SKIN.**

VEHICLE WARNINGS

! Use **ONLY** the vehicle's 3-point lap-and-shoulder belt system when restraining a child in this booster seat. **DO NOT** use this booster seat with 2-point vehicle belts (lap-belt only or shoulder-belt only). Your child would be seriously injured in the event of a crash.

! **DO NOT** use this booster seat if it can't be properly installed. It is possible that your vehicle has no suitable seating position for this booster seat due to seat belt type, airbag system and/or lack of location of a tether strap anchor. Read and follow these instructions, and your vehicle owner's manual carefully.

AIRBAG WARNINGS

! **NEVER PLACE THIS BOOSTER SEAT IN A VEHICLE SEATING LOCATION THAT HAS AN ACTIVE FRONTAL AIRBAG.** An inflating airbag may cause serious injury or death. Refer to your vehicle owner's manual for information about airbags and child restraint installation.

This booster seat may be used in a rear seating position equipped with side impact airbags providing they are:

- Roof mounted;
- "Curtain" type deployment;
- Will **NOT** interfere with, impact or in any way reposition the booster seat when inflated.

! If a vehicle's front seat location must be used, **ALWAYS** disable the airbag. Failure to disable the airbag system can result in serious injury or death. Follow the vehicle owner's manual for instructions on disabling the front airbag system.

Please refer to your vehicle owner's manual for airbag type, and for appropriate use with child restraints.

DAMAGE WARNINGS

- ! It is recommended that the device should be changed when it has been subject to violent stresses in an accident.
- ! **DO NOT USE A BOOSTER SEAT THAT HAS BEEN IN AN ACCIDENT OF ANY KIND.** An accident can cause damage to the booster seat that you cannot see.
- ! **DO NOT** use this booster seat if it is damaged in any way or has missing parts.
- ! **NEVER** use a cut, frayed or damaged vehicle seat belt or harness.
- ! **DO NOT** tamper with or modify the booster seat, for any reason. Any unauthorised alterations or additions to the device without the approval of the Type Approval Authority can cause serious injury or death in a sharp turn, sudden stop, or crash.
- ! **DO NOT** use anything to raise the booster seat off the vehicle seat. Untested modifications, such as adding extra padding, could affect the safety of the booster seat and result in serious injury or death in a crash.
- ! **DO NOT, EXCEPT AS DESCRIBED IN THESE INSTRUCTIONS, MODIFY YOUR BOOSTER SEAT, DISASSEMBLE ANY PART OR CHANGE THE WAY THE VEHICLE SEAT BELTS OR LATCH ARE USED.** This includes any accessories or parts by other manufacturers as non-tested accessories can affect the safety of the booster seat.

AIRCRAFT INSTALLATION

This booster seat is **NOT CERTIFIED** for aircraft use. Aircraft seats are not equipped with 3-point lap-and-shoulder belts which are required for use with this booster seat.

CARE AND MAINTENANCE

CLEANING YOUR SEAT COVER:

- **MACHINE WASH SEPARATELY** using cold water - delicate cycle.
- **DO NOT BLEACH.**
- **DRIP DRY** to prevent cover from shrinking.

! **DO NOT** wash EPE foam pad insert under seat cover.

CLEANING THE PLASTIC SHELL:

- **SPONGE CLEAN** using warm water and mild soap.
- **TOWEL DRY.**
- **DO NOT** use solvents, abrasive cleaners, or disassemble booster seat in any way, except as instructed.

CLEANING LATCH STRAPS AND METAL PARTS:

- Spot clean with a damp cloth.
- **DO NOT BLEACH.**
- **DO NOT** immerse the straps in water. Doing so may weaken the straps.

WARRANTY

LIMITED 2-YEAR WARRANTY

The following warranty conditions only apply to the country in which this product was first sold through retail channels to a consumer.

This booster seat is warranted against defective materials and workmanship for 2 years from the date of original purchase. *An original receipt is required to validate your warranty.* HJP will, at its option, provide replacement parts for this product or replace this product. HJP reserves the right to discontinue or change fabrics, parts, models or products, or to make substitutions.

To make a claim under this warranty, you must contact HJP Customer Service at **www.harmonyjuvenile.com**, or call +44 (0) 1704 549881, or write to 10 Beach Priory Gdns., Southport, UK, PR8 1RT.

Proof of purchase is required and shipping charges are the responsibility of the consumer.

WARRANTY LIMITATIONS

This warranty does not include:

1. Damages which arise from negligence, misuse, or use not in accordance with this instruction manual.
2. Damage and wear arising from excessive stress.
3. Replacement of fabric as a result of natural wear or fading of the fabric as a result of exposure to the sun or UV radiation.

The use of non-Harmony branded covers, inserts, toys, accessories or tightening devices is not approved by HJP. Their use could cause this booster seat to fail federal safety standards or perform worse in a crash. Their use automatically voids the HJP warranty.

LIMITATIONS OF DAMAGES

The warranty and remedies as set forth above are exclusive and in lieu of all others, oral or written, expressed or implied. In no event will HJP or the retailer selling this product be liable to you for any damages, including incidental or consequential damages, or loss of use arising out of the use or inability to use this product.

PLEASE REGISTER THIS BOOSTER SEAT WITHIN 30 DAYS OF PURCHASE TO EXPEDITE WARRANTY CLAIMS AND TO VERIFY ORIGINAL DATE OF PURCHASE.

NOTES

NOTES
