

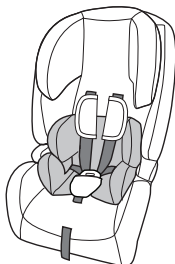

## **GENESYS CAR SEAT INSTRUCTION MANUAL**



This child restraint complies with ECE regulations for use by children:

- Group I / II / III
- Mass: 9 to 36 kg

Suitable for children from 9 to 18 kg (with built-in harness)

Suitable for children from 15 to 36 kg (as high-back booster)

For children approx. 9 months - 12 years

### **READ THIS MANUAL**

Do not install or use this child restraint until you read and understand the instructions in this manual and in your vehicle owner's manual.

**FAILURE TO PROPERLY USE THIS CHILD RESTRAINT INCREASES THE RISK OF SERIOUS INJURY OR DEATH IN A SHARP TURN, SUDDEN STOP OR CRASH.**



**IF YOU HAVE ANY PROBLEMS, PLEASE DO NOT RETURN THIS PRODUCT TO THE PLACE OF PURCHASE. PLEASE CONTACT CUSTOMER SERVICE AT +44 (0) 1704 549881 OR AT [WWW.HARMONYJUVENILE.COM](http://WWW.HARMONYJUVENILE.COM)**

## REGISTRATION INFORMATION

---

**REGISTER YOUR CHILD RESTRAINT TODAY!** Child restraints could be recalled for safety reasons. You must register this restraint to be reached in a recall, and to be eligible to receive replacement parts while under warranty.

The model number, serial number and manufacturing date can be found on a label on the underside of the child restraint.

**Visit [www.harmonyjuvenile.com/uk/register](http://www.harmonyjuvenile.com/uk/register) to register your child restraint online, mail-in the registration card or send your name, address, the restraint's model number, manufacturing date and date of purchase to:**

**Harmony Juvenile Products UK  
10 Beach Priory Gdns.  
Southport, UK  
PR8 1RT  
or call: +44 (0) 1704 549881**

For recall information, any questions you may have, or to make a change of address or contact information please call Customer Service at +44 (0) 1704 549881 or visit us online at **[www.harmonyjuvenile.com](http://www.harmonyjuvenile.com)**.

**PLEASE DO NOT SEND IN YOUR REGISTRATION CARD IF  
YOU HAVE REGISTERED YOUR RESTRAINT ONLINE.**

## IF YOU NEED HELP

---

Please fill in the information below for future reference. The model number and manufacturing date can be found on a label on the underside of the child restraint.

**Model Number:** \_\_\_\_\_

**Manufacture Date:** \_\_\_\_\_

**Date of Purchase:** \_\_\_\_\_

Our Customer Service Department is standing by to help you with any questions or concerns you may have regarding installation, use, care and/or parts. Please have your product's model number and manufacturing date available when contacting us.

## PARTS LIST

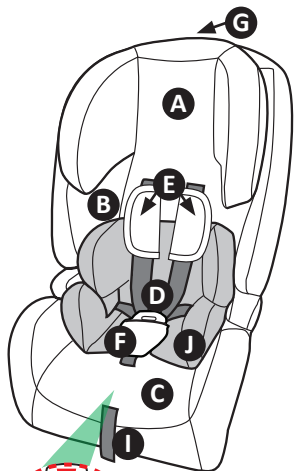

- A** Headrest fabric cover (pre-installed)
- B** Backrest fabric cover (pre-installed)
- C** Base fabric cover (pre-installed)
- D** Harness straps, buckle and clips
- E** Shoulder pads
- F** Crotch strap and pad
- G** 1-hand headrest height adjustment handle (under headrest fabric)
- H** Harness metal adjustment button (above strap, under fabric)
- I** Up-front harness adjustment strap
- J** Infant insert pad
- K** Top Tether
- L** Isofix Connectors
- M** Harness splitter plate
- N** Mesh storage pouch
- O** Backrest plate
- P** Locking clip

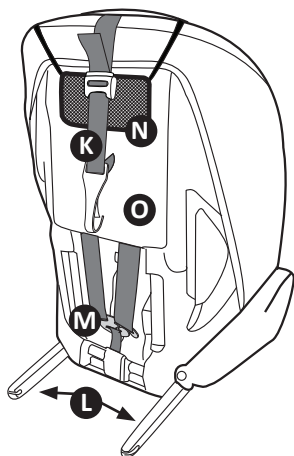

### TO PURCHASE REPLACEMENT PARTS:

In the United Kingdom, please contact us at  
[www.harmonyjuvenile.com](http://www.harmonyjuvenile.com)  
or by calling +44 (0) 1704 549881.

## PREPARING CHILD RESTRAINT FOR USE

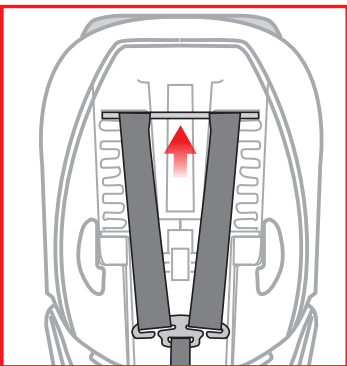
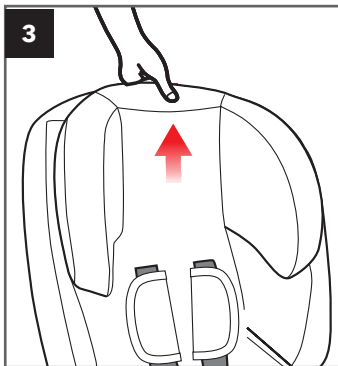
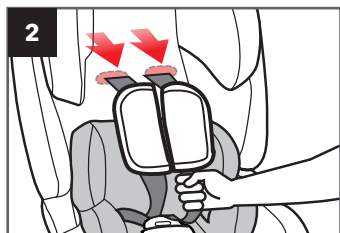
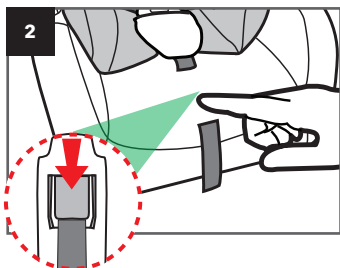
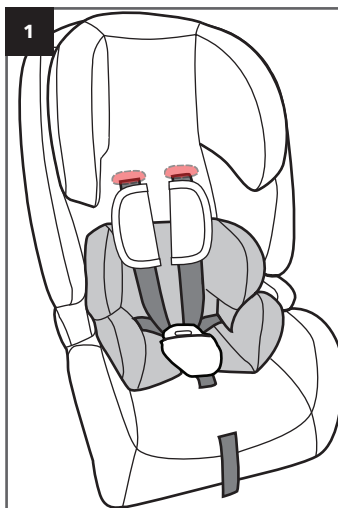

## ADJUSTING CROTCH STRAP POSITION

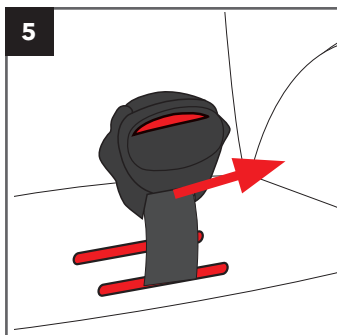

## INSTALLING WITH ISOFIX SYSTEM & TOP TETHER

GROUP 1 (9 - 18 KG)

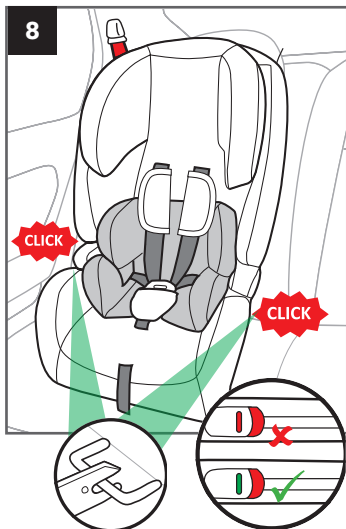
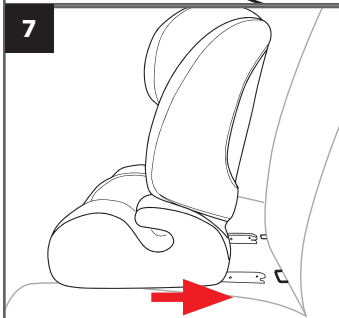
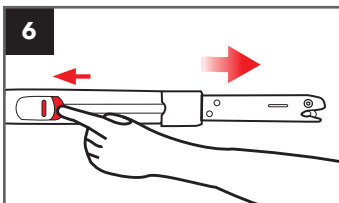

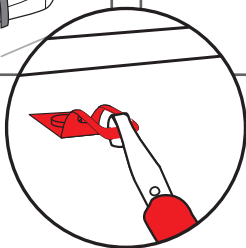
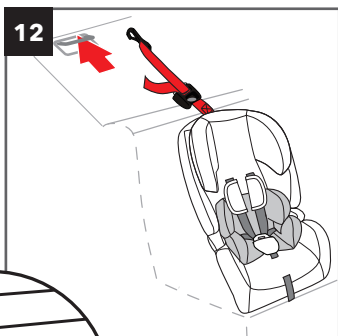
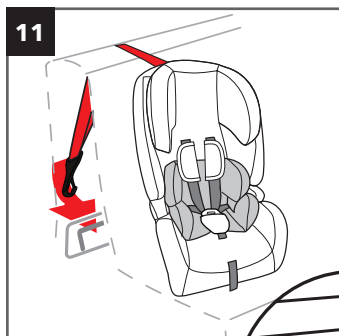
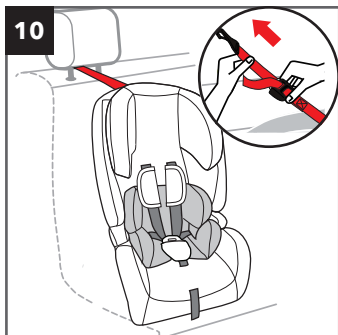
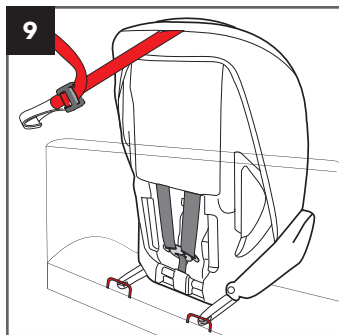

# INSTALLING WITH VEHICLE SEAT BELT

GROUP 1 (9 - 18 KG)

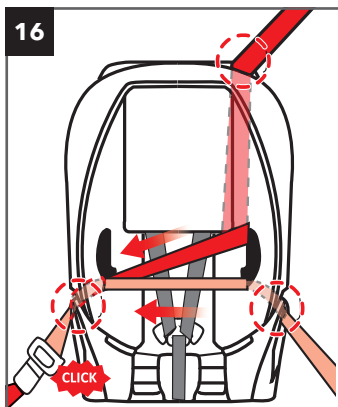
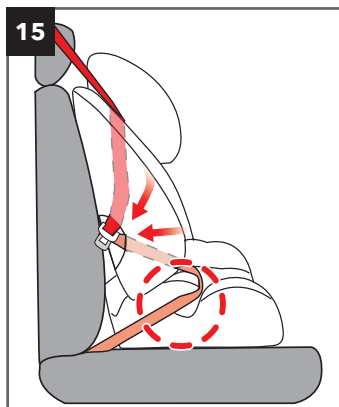
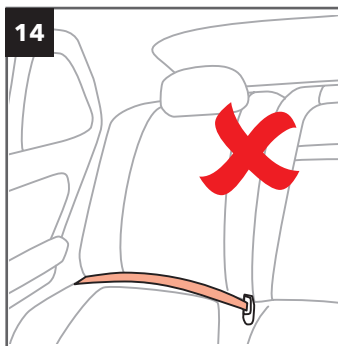
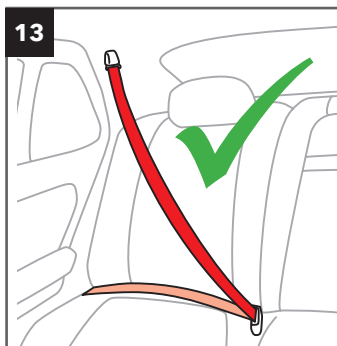

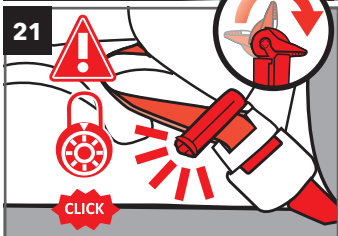
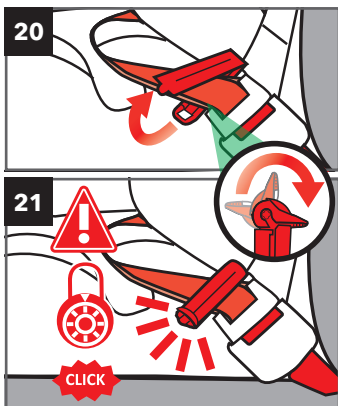
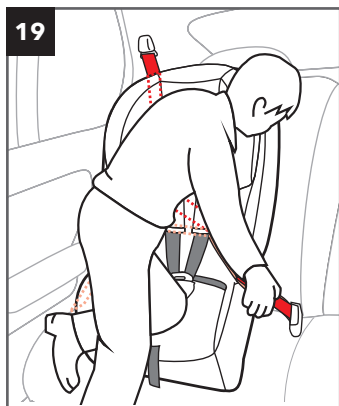
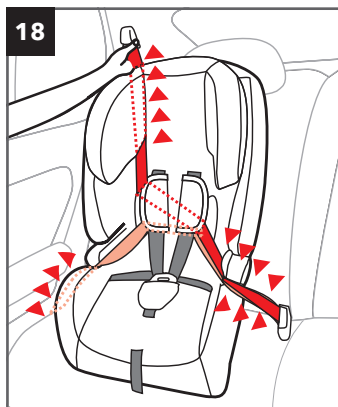
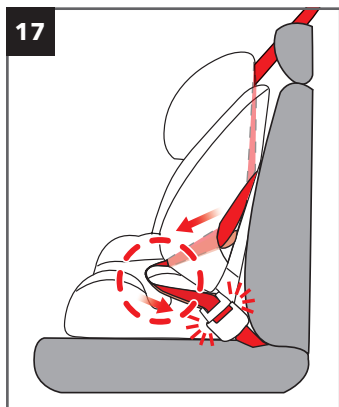



## USING CHILD RESTRAINT WITH BUILT-IN HARNESS

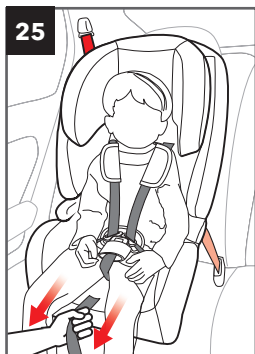
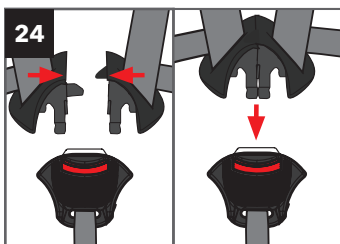
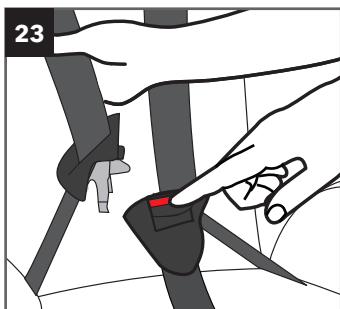
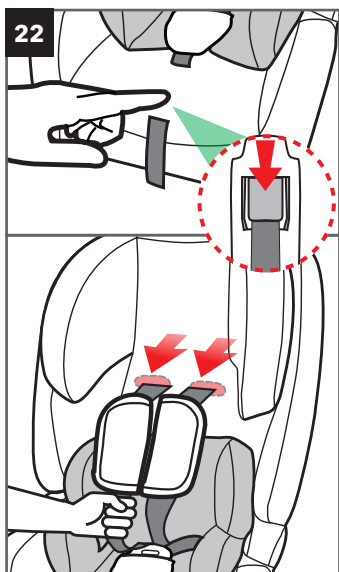

## PREPARING BOOSTER SEAT FOR USE

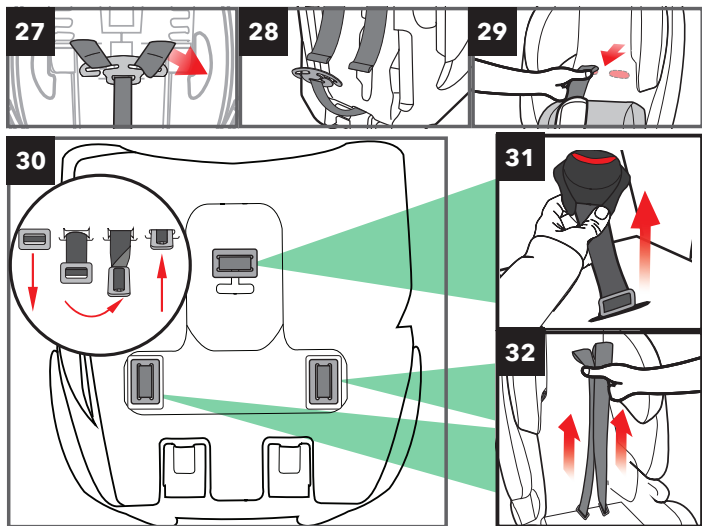

## SECURING CHILD AND BOOSTER SEAT IN VEHICLE

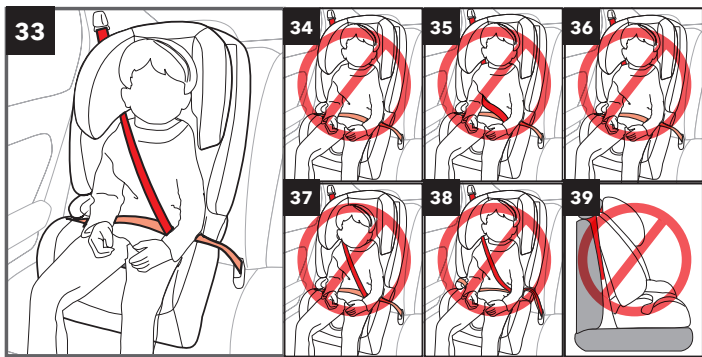

# INSTALLING WITH (OR WITHOUT) ISOFIX SYSTEM & VEHICLE SEAT BELT GROUP 2 & 3 (15 - 36 KG)

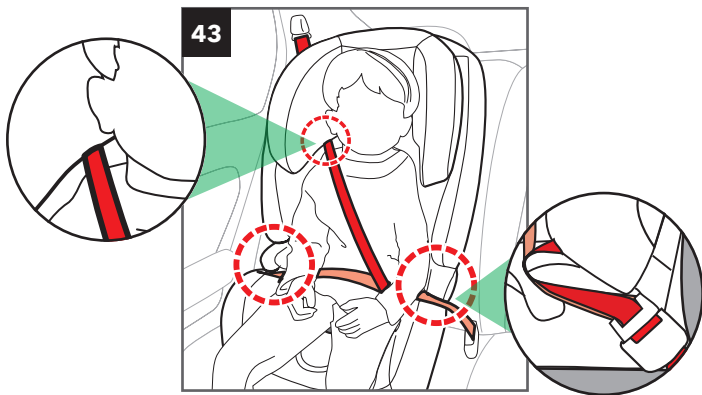
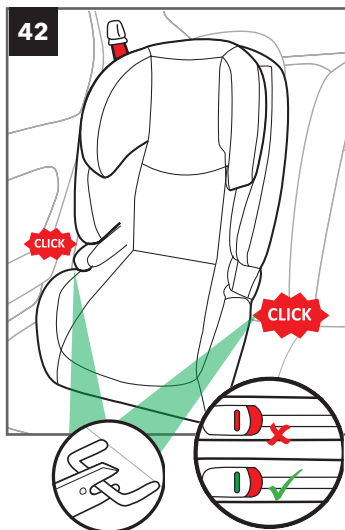
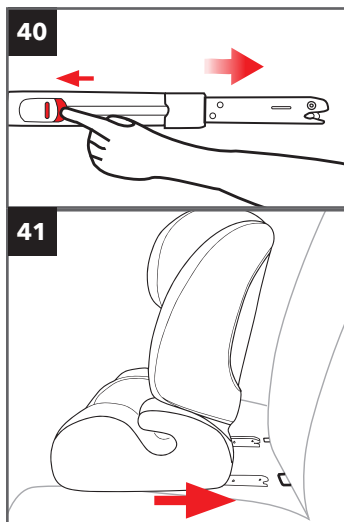

## REMOVING/INSTALLING FABRIC SEAT COVER

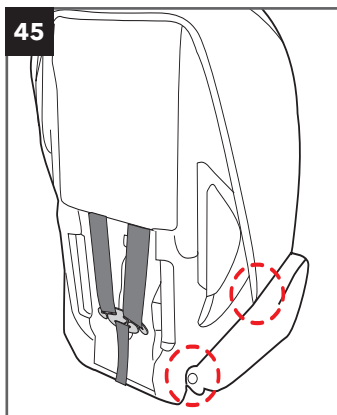
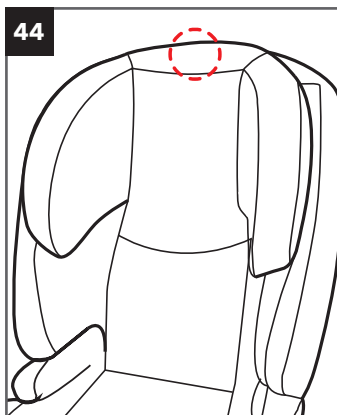

### CERTIFICATIONS

This is a "Universal" child restraint when installed using the 3-point vehicle seat belt only. It is approved to the requirements of the European Standard for Child Safety Seat Equipment under Regulation No. 44, 04 series of amendments, for general use in vehicles and it will fit most, but not all, car seats.

A correct fit is likely if the vehicle manufacturer has declared in the vehicle handbook that the vehicle is capable of accepting a "Universal" child restraint for this age group.

This child restraint has been classified as "Universal" under more stringent conditions than those which applied to earlier designs which do not carry this notice.

This child restraint is classified for "Semi-Universal" use when installed using the Isofix connectors in conjunction with the 3-point vehicle seat belt (certain models only) and is suitable for fixing into the seat positions of the cars listed on [www.harmonyjuvenile.com/uk/resources](http://www.harmonyjuvenile.com/uk/resources).

If in doubt, consult either the child restraint manufacturer or the retailer.

**!** Only suitable for use in the listed vehicles fitted with 3-point with retractor safety-belts, approved to ECE Regulation No. 16 or other equivalent standards.

This restraint is **NOT CERTIFIED** for aircraft use.

This child restraint must **NOT** be used in homes, boats, buses, motorcycles, motor homes, or any other vehicles that have non-forward-facing seats, missing seat belts, or whose seat belts do not meet the requirements of this child restraint.

## PREPARING CHILD RESTRAINT FOR USE



# WARNING!

**INCORRECT USE OF THE HARNESS SYSTEM IS THE MOST COMMON MISTAKE PEOPLE MAKE. IT IS VERY IMPORTANT TO READ, UNDERSTAND AND FOLLOW ALL INSTRUCTIONS AND WARNINGS. DO NOT MISTAKE COMFORT FOR SAFETY. THE HARNESS SYSTEM MUST BE SNUGLY ADJUSTED AT ALL TIMES.**

## ADJUSTING HARNESS SHOULDER STRAPS

**! ENSURE** the harness height is correct for your child's size. **VERIFY OFTEN (1).**

1. Loosen harness system by pushing the up-front metal harness adjuster at the front of the seat **JUST ABOVE** the adjustment strap (under the fabric) and by simultaneously pulling the chest harness straps towards you **(2)**.

**TIP: PULL ON THE HARNESS STRAPS. DO NOT PULL ON THE SHOULDER PADS AS THEY ARE LOCKED IN PLACE.**

2. To determine what harness height is appropriate for your child, have your child sit in the child restraint with their back flat against the backrest.
3. Reach into the opening on the top of the headrest fabric cover and find the **RED** one-hand headrest height adjustment button.
4. Squeeze button and lift the headrest until the shoulder straps are at or just above your child's shoulders **(3)**. The child restraint has **EIGHT** headrest height adjustments.
5. Release the button and listen for a 'click' to make sure harness is locked in place.

**! WARNING:** To ensure headrest is locked in position, gently push down on headrest.

**! ENSURE BOTH HARNESS STRAPS ARE PROPERLY SECURED ON THE SPLITTER PLATE.**

**! WARNING:** The shoulder harness must be **EVEN OR SLIGHTLY ABOVE** the child's shoulders **(A)**. If the upper most harness position is below the child's shoulders, **DO NOT** use this child restraint with harness.

**! WARNING: DO NOT** use this child restraint if the midpoint of your child's head is above the top of the child restraint's headrest at its maximum height **(B)**.

**REMEMBER** to check the shoulder straps position frequently and move them to the next position when necessary. The harness straps **MUST** be in the height position **EVEN WITH** or **just ABOVE** the shoulders. The harness pads and crotch pads are optional and are not a safety feature.

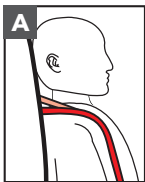



# WARNING!

**FAILURE TO REINSTALL THE HARNESS STRAPS CORRECTLY COULD RESULT IN SERIOUS INJURY OR DEATH.**

## ADJUSTING CROTCH STRAP POSITION

The crotch strap has two (2) positions.

1. Remove fabric crotch pad.
2. Push the buckle down through the fabric seat cover towards the plastic base of the child restraint.
3. Lift the fabric seat cover on the base of the child restraint to expose the buckle and slot positions.
4. Guide the crotch strap through the plastic base to the desired slot position **(4)**.

**! ENSURE** that the strap is **COMPLETELY** in the desired slot and the harness strap is **NOT** twisted. Gently pull upwards to ensure it is firmly in place.

**! ENSURE** that the buckle is facing **FORWARD (5)**.

5. Push the buckle upwards through the fabric seat cover.
6. Replace fabric seat cover and fabric crotch pad.



# WARNING!

**FAILURE TO REINSTALL THE CROTCH STRAPS CORRECTLY COULD RESULT IN SERIOUS INJURY OR DEATH.**

## INSTALLING CHILD RESTRAINT IN HARNESS MODE: ISOFIX AND TOP TETHER

**Isofix** is used for installing the child restraint **IN CONJUNCTION WITH** the use of the Top Tether.

**! Isofix** connectors can **ONLY** be used if your vehicle has the Isofix anchors installed and designated Isofix seating positions. Check your vehicle owner's manual to see which seating positions may be suitable with Isofix.

If an Isofix installation is not an option, then the Isofix option can **NOT** be used in your vehicle. Use the belt-only installation method.

## ISOFIX

If your vehicle is equipped with Isofix anchors, the vehicle Isofix anchorage points may be visible at the seat crease. If not visible, they may be marked with this symbol.



**Check your vehicle owner's manual for your vehicle's exact Isofix locations, anchor identifications and usage requirements for use with a child restraint.**

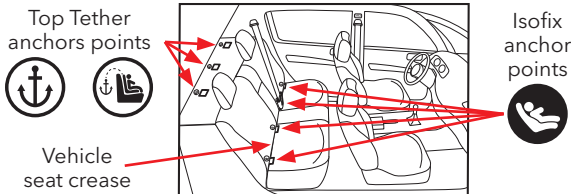

**! WARNING:** CONSULT YOUR VEHICLE OWNER'S MANUAL FOR THE EXACT PLACEMENT OF THESE ELEMENTS IN YOUR VEHICLE, AND FOR MAXIMUM ISOFIX WEIGHT ALLOWANCES PRIOR TO INSTALLATION AS SOME MANUFACTURERS HAVE LOWER MAXIMUM WEIGHT ALLOWANCES FOR ISOFIX USAGE.

## USING TOP TETHER

Your vehicle's Top Tether Anchor Points may be identified using one of these symbols:

- Check that the Top Tether is securely attached to the child restraint.
- Fasten Top Tether clip to anchor point ensuring the clip is facing downwards and the strap is not twisted **(C)**.



- With the child restraint installed with the Isofix or vehicle seat belt, tighten the Top Tether strap securely by pulling on the free end of the Top Tether strap **(D)**.
- To loosen, press the Top Tether release button **(E)**.

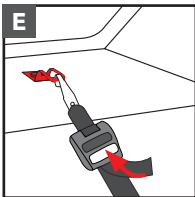
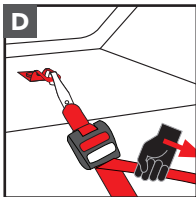
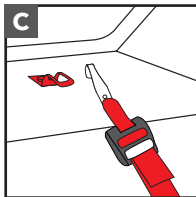

**! WARNING:** Ensure that Top Tether strap is **NOT** twisted.

# INSTALLING WITH ISOFIX SYSTEM & TOP TETHER

## GROUP 1 (9 - 18 KG)

1. Identify the Isofix connectors located at the rear of the seat base.
2. Press the Isofix Release Button on each Isofix arm to release the two Isofix arms for installation **(6)**.
3. Place the child restraint flush against a forward-facing vehicle seat, centered between the Isofix anchors. The child restraint must be level, stable and not rock side-to-side **(7)**.
4. Gently guide the Isofix connectors against the anchors, engaging the Isofix connectors. An audible "click" will be heard when engaged **(8)** and the indicator window will turn **GREEN**.
5. Secure the top of the child restraint using the Top Tether strap **(9)** by fastening the Top Tether clip to the anchor point available in your vehicle as shown **(10, 11, 12)** (see "Using Top Tether").

## DISENGAGING ISOFIX CONNECTORS

To release the Isofix connectors:

Press the Isofix Release Button on each side of the Isofix connectors **(F)**.



## INSTALLING WITH VEHICLE SEAT BELT

### GROUP 1 (9 - 18 KG)

- !** Use **ONLY** the vehicle's 3-point lap-and-shoulder belt system when restraining this child restraint to the vehicle **(13)**. **DO NOT** use this child restraint with a 2-point vehicle belt **(14)**. Your child would be seriously injured in the event of a crash.
1. Place the child restraint flush against a forward-facing vehicle seat. The vehicle seat **MUST** be equipped with a 3-point lap-and-shoulder belt. The child restraint must be level, stable and not rock side-to-side.
  2. Thread the vehicle shoulder belt portion of the seat belt behind the headrest **ON THE SAME SIDE** as the seat belt retractor **(15)**.
  3. Open harness system and lift insert cushion. Thread the lap portion of the vehicle's seat belt through the red belt base positioning guide **ON THE SAME SIDE** as the seat belt retractor **(15)**. Replace insert cushion.
  4. From **BEHIND** the child restraint, pass both the lap and shoulder portions around the rear of the seat and back through the opening **(15)** on the opposite side of the seat as indicated **(16)**. Take both portions of the vehicle seat belt and guide them over the side of the child restraint **(17)**.
  5. Buckle the vehicle seat belt. Listen for an audible "click" **(15)**. The vehicle seat belt **MUST NOT** be twisted.



6. If your vehicle is equipped with a ELR/ALR switchable seat belt retractor system, we recommend that you pull out the full length of the vehicle seat belt (until you cannot pull out any more slack). This locks the retractor. If not equipped with switchable ELR/ALR retractor, continue with step #7.
7. Tighten vehicle seat belt by placing your knee on the child restraint base and by using your full weight to push the child restraint down as you simultaneously release the extra belt length until seat belt is taught and has no slack **(19)**. Manually pull out of all of the slack from the **LAP PORTION (18)** and then feed the shoulder portion back into the retractor.
8. Attach the locking clip around both lap and shoulder belts once vehicle seat belt is adjusted and tightened **(20, 21)**.

For more information on how to tighten the seat belt for your seat belt system, see your vehicle owner's manual.

## USING CHILD RESTRAINT WITH BUILT-IN HARNESS



**FAILURE TO FASTEN AND TIGHTEN THE HARNESS SYSTEM CORRECTLY MAY CAUSE THE CHILD TO BE EJECTED FROM THE RESTRAINT SYSTEM IN CASE OF A SHARP TURN, SUDDEN STOP OR CRASH CAUSING SERIOUS INJURY OR DEATH.** In a crash, the child restraint will provide **NO** protection for your child unless the harness straps are properly secured. **DO NOT** mistake comfort for safety. Harness system **MUST** be snugly adjusted. Follow these instructions carefully.

- ! Incorrect use of the harness system is the most common mistake people make. It is **VERY** important to read, understand and follow **ALL** instructions and warnings. **DO NOT** mistake comfort for safety. The harness system **MUST** be snugly adjusted at all times.
- ! Snugly adjust the harness provided with this child restraint around your child. A snug strap is one with no slack. It should not press on the child's flesh or cause your child's body to be in an unnatural position. You should only be able to slide **ONE FINGER** between the shoulder straps and the child's shoulder.
- ! Avoid unnecessary bulky clothing.

## SECURING CHILD IN CHILD RESTRAINT

1. To loosen the harness strap: Push the up-front metal harness adjuster at the front of the seat just **ABOVE** the adjustment strap (**UNDER THE FABRIC**) and simultaneously pull the chest strap towards you **(22)**.  
**TIP: PULL ON THE HARNESS STRAPS. DO NOT PULL ON THE SHOULDER PADS AS THEY ARE LOCKED IN PLACE.**
2. Unbuckle harness straps by pressing on the **RED** buckle release button and by pulling the buckle clips out **(23)**. Move harness straps to the side.

3. Place child in child restraint with child's back flat against back of the backrest.
4. Adjust headrest height (see "Adjusting harness shoulder straps").
5. Place harness straps over child's shoulders. Hold the two buckle clips together and insert the two-piece buckle clip into buckle until they 'click' into place **(24)**.  
**! ENSURE** that the buckle is properly fastened by gently tugging on it.  
**! ENSURE** that the straps are **NOT** twisted.  
**! DO NOT** use child restraint if harness does not lock.
6. Tighten harness system by gently pulling on the up-front harness adjuster strap until all slack is removed from the system **(25)**.  
**! ENSURE** straps are flat and snug against child's shoulders and thighs. You should **NOT** be able to slide more than one finger between the strap and the child's shoulder **(26)**.  
A snug strap should not allow any slack. It lies in a relatively straight line without sagging. It should not press the child's flesh or cause your child's body to be in an unnatural position.  
**! Any** straps holding the restraint to the vehicle should be tight, any straps restraining the child should be adjusted to the child's body, and all straps should not be twisted.

## REMOVING CHILD FROM CHILD RESTRAINT

---

1. Loosen the harness system by pressing on the up-front metal harness adjuster **(UNDER THE FABRIC)**, and simultaneously pulling the shoulder straps towards you.
2. Unbuckle harness by pressing on the **RED** buckle release button.

## USING CHILD RESTRAINT IN BOOSTER MODE (WITHOUT BUILT-IN HARNESS)

---

**IF YOUR CHILD HAS REACHED 15 KG, YOU CAN USE THE SEAT IN BOOSTER MODE.**

**! DO NOT** use infant insert in booster mode.

Harmony Juvenile Products advises that your child remains in a 5-point harness for as long as possible per the mass and height requirements of the child restraint.

1. Open harness buckle.
2. Face the rear of the child restraint and remove the harness straps from the splitter plate **(27, 28)**.
3. Pull harness straps out of their respective slots in the backrest **(29)**.
4. Lie child restraint on its side and find the metal locking plate for each harness strap on the underside of the base of the child restraint. Grasp the strap and turn each metal plate **(30)** so that it can slide up and out through the plastic seat base **(32)**.
5. Repeat procedure for crotch strap **(31)** and Top Tether removal.

6. Store complete harness system for future use.
7. Pull the up-front harness adjustment strap as far as it will go. This will lock the splitter plate into the base of the seat.
8. Roll strap tightly, secure roll with an elastic band and store rolled strap under the fabric seat cover in the opening of the up-front adjuster.

To reinstall, remove backrest plate and repeat these steps in reverse order. When re-inserting the shoulder straps through the backrest, ensure the straps are **ABOVE** the metal bars inside the slots in the backrest. Reinstall backrest plate once harness is properly reinstalled.



## WARNING!

**FAILURE TO REINSTALL THE HARNESS SYSTEM AND CROTCH STRAP CORRECTLY COULD RESULT IN SERIOUS INJURY OR DEATH.**

### PREPARING BOOSTER SEAT FOR USE



## WARNING!

**INCORRECT USE OF THE VEHICLE'S 3-POINT LAP-AND-SHOULDER SEAT BELT SYSTEM IS THE MOST COMMON MISTAKE PEOPLE MAKE. IT IS VERY IMPORTANT TO READ, UNDERSTAND AND FOLLOW ALL INSTRUCTIONS AND WARNINGS. DO NOT MISTAKE COMFORT FOR SAFETY. THE VEHICLE'S 3-POINT LAP-AND-SHOULDER SEAT BELT MUST BE SNUGLY ADJUSTED AT ALL TIMES.**

**! ENSURE** the vehicle shoulder belt's position is correct for your child's size. **VERIFY OFTEN.**

**! WARNING: DO NOT** use this booster seat if the midpoint of your child's head is above the top of the booster seat headrest at its maximum height.



# **WARNING!**

- ! ALWAYS** ASSIST YOUR CHILD WHEN GETTING INTO AND OUT OF YOUR CHILD RESTRAINT/BOOSTER SEAT.
- ! NEVER** LET YOUR CHILD LEAN ON THE ARMREST WHEN GETTING INTO OR EXITING THE BOOSTER SEAT TO PREVENT THE SEAT FROM TIPPING.
- ! ENSURE** THAT THE BOOSTER SEAT IS LEVEL, STABLE AND DOES NOT ROCK SIDE-TO-SIDE. IF THE BOOSTER SEAT IS NOT STABLE, TRY ANOTHER SEATING LOCATION. IN VEHICLES WITH WIDE, FLAT SEATS, A ROLLED TOWEL CAN BE USED ON THE OUTBOARD (DOOR) SIDE TO ADD STABILITY TO THE BOOSTER SEAT.
- ! DO NOT ADD ANYTHING BEHIND OR UNDER THE BOOSTER SEAT.**



## **SECURING CHILD AND BOOSTER SEAT IN VEHICLE**

# **WARNING!**

**FAILURE TO PROPERLY SECURE YOUR CHILD IN THE BOOSTER SEAT INCREASES THE RISK OF SERIOUS INJURY OR DEATH IN THE EVENT OF A SHARP TURN, SUDDEN STOP OR CRASH.** In a crash, the booster seat provides **NO** protection for your child unless the vehicle 3-point lap-and-shoulder belt is properly secured. Follow these instructions carefully to properly secure your child.

- ! DO NOT** use this booster seat if it can't be properly leveled, stabilized, and installed as per this instruction manual. It is possible that your vehicle has no suitable seating position for this booster seat due to seating surface, seat belt type and/or airbag system. Read and follow these instructions, and your vehicle owner's manual carefully.
- ! WARNING:** You **MUST** use the vehicle 3-point lap-and-shoulder belt system when restraining the child in the booster seat **(33)**.
- ! WARNING:** Vehicle belts **MUST** be tight, adjusted to the child's body, and should not be twisted **(33)**.
- ! NEVER** use a vehicle lap-only belt to secure child in booster seat **(34)**.
- ! NEVER USE A LOOSE SHOULDER BELT.**
- ! NEVER** position the shoulder belt under the child's arm **(35)** or place the shoulder belt behind the child's back **(36)**.

**Lap portion of lap-and-shoulder belt MUST be low and snug across the hips, with the pelvis firmly engaged, just touching the child's thighs.** The lap

portion **MUST NOT** be lying across the child's stomach as this can cause major injuries to the child in case of a sharp turn, sudden stop or crash.

**! DO NOT** allow the child to slouch, slide down in the seat, or create slack in the belt system **(37)**. If child will not keep vehicle belt properly positioned, **DO NOT** use this booster seat.

**! DO NOT** position vehicle belt over top of the armrests **(38)**.

**! The vehicle seat headrest should not create a gap between vehicle seat and booster seat (39).** If so, remove the vehicle headrest.

**! DO NOT** use any load bearing contact points other than those described in the instructions and marked in the child restraint.

**IF IN DOUBT ABOUT THESE POINTS OR ANY QUESTIONS RELATED TO INSTALLATION, PLEASE CONTACT HARMONY JUVENILE PRODUCTS.**

## **INSTALLING WITH (OR WITHOUT) ISOFIX SYSTEM & VEHICLE SEAT BELT GROUP 2 & 3 (15 - 36 KG)**

# **WARNING!**

**DUE TO VARYING ANGLES OF VEHICLE SEAT BELT RETRACTORS, EXCESS SLACK IN THE VEHICLE BELT SYSTEM MIGHT NOT BE REMOVED AUTOMATICALLY.** Once the lap and shoulder portions of the seat belt are properly positioned and the buckle is attached, **FEED ANY REMAINING SLACK OF THE SEAT BELT MANUALLY BACK INTO THE RETRACTOR TO TIGHTEN THE WHOLE SYSTEM.**

1. If your vehicle is equipped with Isofix, press the Isofix Release Button on each Isofix arm to release the two Isofix arms for installation **(40)**. Place the booster seat flush against a forward-facing vehicle seat, centered between the Isofix anchors. The vehicle seat **MUST** be equipped with a 3-point lap-and-shoulder belt. Booster must be level, stable and not rock side-to-side **(41)**.
2. **ISOFIX INSTALLATION:** Gently guide the Isofix connectors against the anchors, engaging the Isofix connectors. An audible "click" will be heard when engaged **(42)** and the indicator window will turn **GREEN**.
3. Place child in the booster seat with child's back flat against the back of the booster seat.
4. Adjust headrest height (see "Adjusting harness shoulder straps").
5. Thread shoulder belt portion of the 3-point lap-and-shoulder belt system behind the headrest **ON THE SAME SIDE** as the seat belt retractor **(43)** and ensure that shoulder belt lies across child's shoulder and chest, and **NOT** across child's face or neck.

6. Thread both sides of the lap belt under BOTH armrests. Thread the lower end of the shoulder belt under the armrest on the buckle side **(43)**. ENSURE that the belt is snug across the child's hips. It is important to ensure that any lap strap is worn low down, so that the pelvis is firmly engaged, just touching their thighs and is NOT across their stomach.

7. Buckle the vehicle seat belt into place and ensure it is secure by gently pulling on it.

**! BOTH SIDES OF THE LAP BELT MUST PASS UNDER BOTH ARMRESTS, AND THE LOWER END OF THE SHOULDER BELT MUST PASS UNDER THE ARMREST ON THE BUCKLE SIDE.**

**!** Any straps holding the restraint to the vehicle should be tight, any straps restraining the child should be adjusted to the child's body, and all straps should not be twisted.

**! NEVER USE A VEHICLE LAP-ONLY BELT WHEN USING THIS BOOSTER SEAT.**

---

## REMOVING/INSTALLING FABRIC SEAT COVER

---

### TO REMOVE

Remove harness system.

#### HEADREST:

1. Gently slide fabric downwards off the top of the headrest. **(34)**.

#### BACKREST:

1. Undo the fabric hook-and-loop fastener tabs (x2) **(35)** along the bottom sides of the backrest (where the backrest meets the base).
2. Gently slide fabric cover off the backrest.
3. Remove EPE foam from backrest fabric.

#### BASE:

1. Undo the snaps (x2) behind the seat **(35)** as indicated.
2. Gently slide the fabric cover off the plastic base from the back of the child restraint towards the front of the seat.

### TO INSTALL

To reinstall fabric covers, repeat previous steps in reverse order.

**! CAUTION:** Reinstall harness system if applicable.

---

## INSTRUCTION MANUAL STORAGE

---

We recommend that you store your instruction manual in the mesh pocket provided under the fabric on the side of the child restraint.

## WARNINGS

### GENERAL WARNINGS



## WARNING!

The safety of your child and the effectiveness of this child restraint depend on:

1. **Selecting a suitable location** for the child restraint in your vehicle.
2. **Properly routing the vehicle seat belt.**
3. **Properly securing both your child and the child restraint in the vehicle.**

Many seat belts are **NOT** safe to use with this child restraint. If in doubt about installing this child restraint, consult the vehicle owner's manual or call the Harmony Customer Service Department.



## WARNING!

**FAILURE TO PROPERLY READ, FOLLOW AND USE THESE INSTRUCTIONS AND THE CHILD RESTRAINT LABELS INCREASES THE RISK OF SERIOUS INJURY OR DEATH IN A SHARP TURN, SUDDEN STOP OR CRASH.** Your child's safety depends on the proper installation and use of this child restraint. Even if this child restraint seems easy to install and use, it is **VERY IMPORTANT** to read and understand these instructions and the vehicle owner's manual.

Follow all labels on this child restraint and in these written instructions. **DO NOT INSTALL OR USE THIS CHILD RESTRAINT UNTIL YOU READ AND UNDERSTAND THE INSTRUCTIONS IN THIS MANUAL AND IN YOUR VEHICLE OWNER'S MANUAL.**

**NO CHILD RESTRAINT CAN GUARANTEE PROTECTION WHEN THE VEHICLE IS SERIOUSLY IMPACTED.** However, when correctly installed, a child restraint will substantially improve the chances for survival and reduce the risk of serious injury in most crashes.

Carefully follow the instructions in this manual and in your vehicle owner's manual. If there is a discrepancy between the two, the vehicle owner's manual must take precedence with regards to seat belts and/or airbags.

**! DO NOT** allow children to play with this child restraint.

**! NEVER** leave children alone in a vehicle under any circumstance.

**! It is recommended that children are not left in their child restraint system unattended.**

**! Set a good example by ALWAYS** wearing your seat belt. Make it a firm rule that the vehicle does not move until everyone is buckled up. **MAKE NO EXCEPTIONS.**

- ! Harmony Juvenile Products advises against loaning or passing along a child restraint. **DO NOT USE A SECOND-HAND CHILD RESTRAINT** or a child restraint whose history you do not know.
- ! When disposing a child restraint system, ensure to dispose of the unit in a way others cannot reuse it (e.g. use a dark trash bag, do not sell to a thrift shop or in a garage sale, etc.).
- ! Store the child restraint in a safe place when not in use. **DO NOT** place heavy objects on top of the child restraint while in storage.
- ! **DO NOT** remove any stickers or warnings as they contain important information.

## USAGE WARNINGS



# WARNING!

- ! **ALWAYS** ASSIST YOUR CHILD WHEN GETTING INTO AND OUT OF THE CHILD RESTRAINT.
- ! **ENSURE** THAT THE CHILD RESTRAINT IS LEVEL, STABLE AND DOES NOT ROCK SIDE-TO-SIDE. IF THE CHILD RESTRAINT IS NOT STABLE, TRY ANOTHER SEATING LOCATION.
- ! **DO NOT ADD ANYTHING BEHIND OR UNDER THE CHILD RESTRAINT.**

According to accident statistics, **CHILDREN ARE SAFER WHEN PROPERLY RESTRAINED IN THE REAR SEATING POSITIONS THAN IN THE FRONT SEATING POSITION.**

- ! **DO NOT** use any load bearing contact points other than those described in the instructions and marked in the child restraint.
- ! **DO NOT** allow others to install or use this child restraint unless they read and understand all the instructions and labels.
- ! **DO NOT GIVE THIS CHILD RESTRAINT** to someone else without also giving them this instruction manual. Additional instruction manuals can be downloaded directly from [www.harmonyjuvenile.com](http://www.harmonyjuvenile.com).
- ! To ensure proper child restraint use, keep and store this instruction manual and refer to it when necessary.
- ! **DO NOT LEAVE A CHILD RESTRAINT UNSECURED IN YOUR VEHICLE.** In a collision, sharp turn or sudden stop, an unsecured child restraint can injure other occupants. Remove it or make sure that it is securely attached with the vehicle seat belt, even when not in use.



## INJURY WARNINGS

---

- ! **INJURIES MAY OCCUR EVEN IF YOU ARE NOT IN A CRASH** if the child restraint is not properly installed or if your child is not properly secured in the child restraint.
- ! The rigid items and plastic parts of a child restraint shall be so located and installed that they are not liable, during everyday use of the vehicle, to become trapped by a movable seat or in a door of the vehicle.
- ! **DO NOT** leave folding vehicle seats unlatched. In the event of a sharp turn, sudden stop or crash, a loose seat back could prevent the child restraint from protecting the child as well as it should.
- ! It is recommended that any luggage or other objects liable to cause injuries in the event of a collision shall be properly secured. In the event of a sharp turn, sudden stop or crash, loose objects will keep moving, potentially causing serious injuries.
- ! The child restraint shall not be used without the cover. It **MUST** always be used with the fabric cover provided by the manufacturer.
- ! The seat cover should not be replaced with any other than the one recommended by the manufacturer, because the cover constitutes an integral part of the restraint performance.
- ! **PARTS OF THE CHILD RESTRAINT COULD BECOME HOT ENOUGH TO BURN THE CHILD IF LEFT IN THE SUN.** Contact with these parts can injure your child. **ALWAYS** touch the surface of any metal or plastic parts before putting your child in the child restraint. Cover the child restraint with a towel or blanket when the vehicle is parked in direct sunlight. **KEEP AWAY FROM SUNLIGHT, OTHERWISE IT MAY BE TOO HOT FOR THE CHILD'S SKIN.**

## VEHICLE WARNINGS

---

- ! **DO NOT** use this child restraint with a 2-point vehicle belt (lap-belt only or shoulder-belt only). Your child would be seriously injured in the event of a crash.
- ! **DO NOT** use this child restraint if it can't be properly installed. It is possible that your vehicle has no suitable seating position for this child restraint due to seat belt type, airbag system and/or lack of location of a tether strap anchor. Read and follow these instructions, and your vehicle owner's manual carefully.

## AIRBAG WARNINGS

---

- ! **NEVER PLACE THIS CHILD RESTRAINT IN A VEHICLE SEATING LOCATION THAT HAS AN ACTIVE FRONTAL AIRBAG.** An inflating airbag may cause serious injury or death. Refer to your vehicle owner's manual for information about airbags and child restraint installation.

This child restraint may be used in a rear seating position equipped with side impact airbags providing they are:

- Roof mounted;

- “Curtain” type deployment;
- Will **NOT** interfere with, impact or in any way reposition the child restraint when inflated.

! If a vehicle’s front seat location must be used, **ALWAYS** disable the airbag. Failure to disable the airbag system can result in serious injury or death. Follow the vehicle owner’s manual for instructions on disabling the front airbag system.

Please refer to your vehicle owner’s manual for airbag type, and for appropriate use with child restraints.

## DAMAGE WARNINGS

---

! It is recommended that the device should be changed when it has been subject to violent stresses in an accident.

! **DO NOT USE A CHILD RESTRAINT THAT HAS BEEN IN AN ACCIDENT OF ANY KIND.** An accident can cause damage to the child restraint that you cannot see.

! **DO NOT** use this child restraint if it is damaged in any way or has missing parts.

! **NEVER** use a cut, frayed or damaged vehicle seat belt or harness.

! **DO NOT** tamper with or modify the child restraint, for any reason. Any unauthorised or additions to the device without the approval of the Type Approval Authority can cause serious injury or death in a sharp turn, sudden stop, or crash.

! **DO NOT** use anything to raise the child restraint off the vehicle seat. Untested modifications, such as adding extra padding, could affect the safety of the child restraint and result in serious injury or death in a crash.

! **DO NOT, EXCEPT AS DESCRIBED IN THESE INSTRUCTIONS, MODIFY YOUR CHILD RESTRAINT, DISASSEMBLE ANY PART OR CHANGE THE WAY THE VEHICLE SEAT BELTS ARE USED.**

This includes any accessories or parts by other manufacturers as non-tested accessories can affect the safety of the child restraint.

## AIRCRAFT INSTALLATION

---

This child restraint is **NOT CERTIFIED** for aircraft use. Aircraft seats are not equipped with 3-point lap-and-shoulder belts which are required for use with this child restraint.

## CARE AND MAINTENANCE

---

### CLEANING YOUR SEAT COVER:

- **MACHINE WASH SEPARATELY** using cold water - delicate cycle.
- **DO NOT BLEACH.**
- **DRIP DRY** to prevent cover from shrinking.

! **DO NOT** wash EPE foam pad insert under seat cover.

### **CLEANING THE PLASTIC SHELL:**

- **SPONGE CLEAN** using warm water and mild soap.
- **TOWEL DRY.**
- **DO NOT** use solvents, abrasive cleaners, or disassemble child restraint in any way, except as instructed.

### **CLEANING HARNESS AND TOP TETHER STRAPS:**

- Spot clean with a damp cloth. **DO NOT BLEACH. DO NOT** immerse the straps in water. Doing so may weaken the straps.

### **CLEANING METAL, PLASTIC HARNESS, AND ISOFIX PARTS:**

- Use mild soap and cool water on a damp cloth.

**! NEVER** lubricate the buckle. If buckle or harness adjuster sticks or will not remain tight, check for foreign objects such as food, dirt, etc. Remove objects with tweezers and/or clean with a cotton swab. If you cannot get the harness to remain tight with the buckle securely locked, **DO NOT USE** this child restraint. Call Harmony Juvenile Products to purchase a replacement harness or buckle.

## **WARRANTY**

---

This child restraint was manufactured by Harmony® Juvenile Products (HJP). HJP warrants this product to the original retail purchaser as follows:

### **LIMITED 2-YEAR WARRANTY**

The following warranty conditions only apply to the country in which this product was first sold through retail channels to a consumer.

This child restraint is warranted against defective materials and workmanship for 2 years from the date of original purchase. *An original receipt is required to validate your warranty.* HJP will, at its option, provide replacement parts for this product or replace this product. HJP reserves the right to discontinue or change fabrics, parts, models or products, or to make substitutions.

To make a claim under this warranty, you must contact HJP Customer Service at **www.harmonyjuvenile.com**, or call +44 (0) 1704 549881, or write to 10 Beach Priory Gdns., Southport, UK, PR8 1RT.

Proof of purchase is required and shipping charges are the responsibility of the consumer.

### **WARRANTY LIMITATIONS**

This warranty does not include:

1. Damages which arise from negligence, misuse, or use not in accordance with this instruction manual.
2. Damage and wear arising from excessive stress.
3. Replacement of fabric as a result of natural wear or fading of the fabric as a result of exposure to the sun or UV radiation.

The use of non-Harmony branded covers, inserts, toys, accessories or tightening devices is not approved by HJP. Their use could cause this child restraint to fail federal safety standards or perform worse in a crash. Their use automatically voids the HJP warranty.

### **LIMITATIONS OF DAMAGES**

The warranty and remedies as set forth above are exclusive and in lieu of all others, oral or written, expressed or implied. In no event will HJP or the retailer selling this product be liable to you for any damages, including incidental or consequential damages, or loss of use arising out of the use or inability to use this product.

**PLEASE REGISTER THIS CHILD RESTRAINT WITHIN 30 DAYS OF PURCHASE TO EXPEDITE WARRANTY CLAIMS AND TO VERIFY ORIGINAL DATE OF PURCHASE.**