

# harmony®

## POP-UP FEEDING CHAIR



### **IMPORTANT! KEEP FOR FUTURE REFERENCE**

Complies with BS EN 16120: 2012+A2:2016

This product is intended for children able to sit unaided (minimum 6 months) and up to 36 months or a maximum weight of 15 kg.

Minimum dimensions of the adult's chair seat: 34.5 cm x 34.5 cm.

Minimum height of the adult's chair backrest: 21.5 cm.



**IF YOU HAVE ANY PROBLEMS, PLEASE DO NOT  
RETURN THIS PRODUCT TO THE PLACE OF PURCHASE.  
PLEASE CONTACT HARMONY CUSTOMER SERVICE AT  
+44 (0) 1704 549881 OR AT [WWW.HARMONYJUVENILE.COM](http://WWW.HARMONYJUVENILE.COM)**

## WARNINGS

### WARNING!

#### Risk of injury or death from falls or sliding out.

- ! **ENSURE** that **ALL** the locking devices are engaged before use.
- ! Before use, **ENSURE** that 2 straps are tightened.
- ! **DO NOT** let the child climb out of or stand on the feeding chair.
- ! **NEVER** leave child unattended.
- ! **ALWAYS** use the restraint system and ensure it is correctly fitted before use.
- ! **ALWAYS** use the chair attachment system and ensure it is correctly fitted before use.
- ! **ALWAYS** check the security and stability of the product on the adult chair before use.
- ! **DO NOT** use this product on stools or benches.
- ! **NEVER** lift this product with your child in it.
- ! **DO NOT** use this product if any part is broken, torn or missing.
- ! This product is intended for children able to sit unaided (minimum 6 months) and up to 36 months or a maximum weight of 15 kg.
- ! For use on a chair of minimum seat dimensions of 34.5 cm (W) x 34.5 cm (D), and minimum backrest height of 21.5 cm.
- ! **ENSURE** the adult chair with the feeding chair is placed where the child is not able to use its feet to push against the table or any other structure as it can cause the tip over of the adult chair supporting the chair mounted seat.
- ! Only use accessories or replacement parts approved by Harmony Juvenile Products.

## PARTS LIST

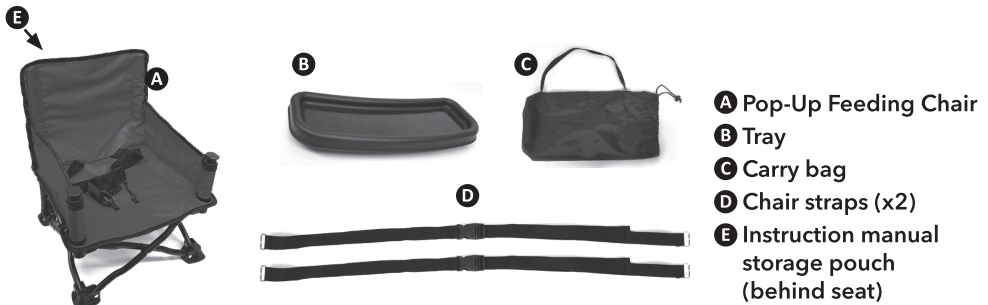

## SETTING UP THE FEEDING CHAIR

### ASSEMBLY



- 1 Remove all contents from packaging, and discard box and polybags. The feeding chair, tray, and chair straps come packed within the carry bag.

**2 TO OPEN:** Use both hands to pull chair frame outward and press down on both front legs until a 'click' is heard on each side.

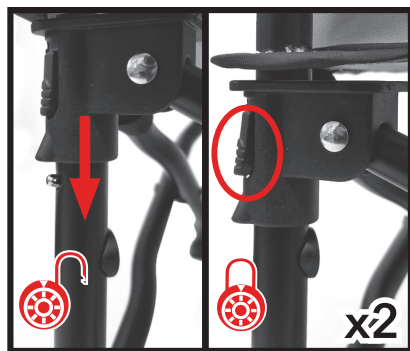

**TO FOLD:** Press release button on each rear leg and slide up locking mechanism on both legs (pull seat frame together).

**3** Squeeze both levers on the tray to slide the tray onto the feeding chair.

**! ENSURE THAT TRAY IS SECURELY INSTALLED ONTO THE FEEDING CHAIR BY GENTLY PULLING OUTWARD.**

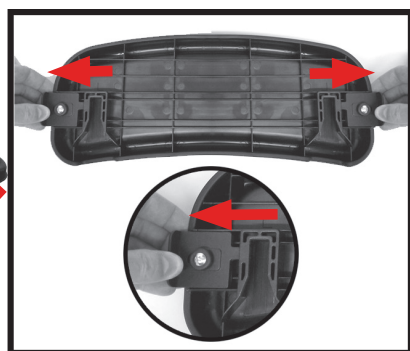

## SECURING FEEDING CHAIR

**4 INSTALLING SECURITY STRAPS:**

Both straps come pre-installed with your product. Should a strap be removed:

Pass one chair strap around rear leg **1** and pass another around the cross bar on one side of the feeding chair **2**. Loop each strap by sliding strap through opening of metal ring **3**.

Repeat same steps for opposite straps on the other side of the feeding chair.

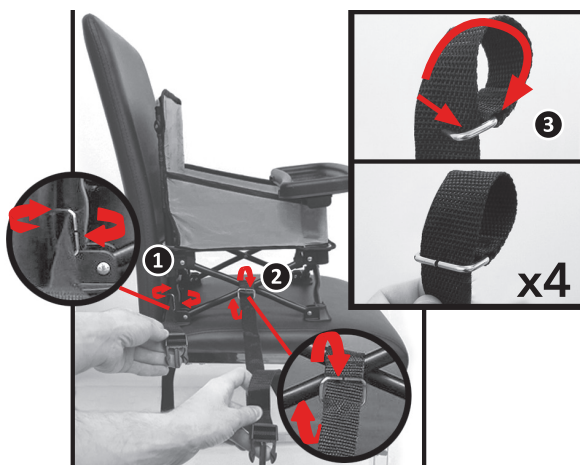

**5** Place feeding chair on adult chair. Fasten rear straps to the back of the adult chair by fastening clips of both straps **1** around the back of the adult chair **2**.

Fasten center bar straps to the bottom of the adult chair by fastening clips of both straps **1** around the bottom of the adult chair **3**. Pull on straps to ensure that chair is tightly secured.

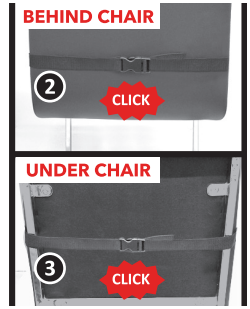

**! ENSURE THAT THE FEEDING CHAIR IS LEVEL, STABLE AND DOES NOT ROCK SIDE-TO-SIDE. IF THE FEEDING CHAIR IS NOT STABLE, TRY ANOTHER ADULT CHAIR.**

## SECURING INFANT TO FEEDING CHAIR

**6** Place infant into feeding chair. Fasten the restraint system by inserting both clips into corresponding buckles (x2) on the feeding chair. Pull straps to tighten **ENSURING** infant is snugly secure within the harness.

**! WARNING: FAILURE TO PROPERLY SECURE YOUR CHILD IN THE FEEDING CHAIR INCREASES THE RISK OF SERIOUS INJURY OR DEATH.** Follow these instructions carefully to properly secure your child.

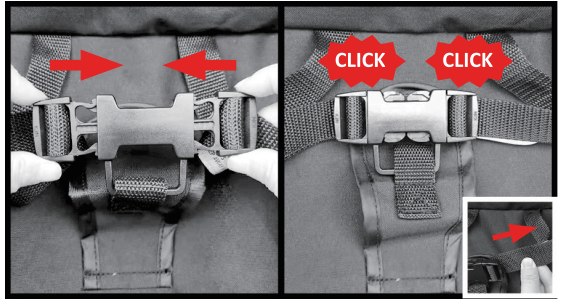

## DISASSEMBLY AND STORAGE

**8** Squeeze both tray levers to slide tray outward off the feeding chair.

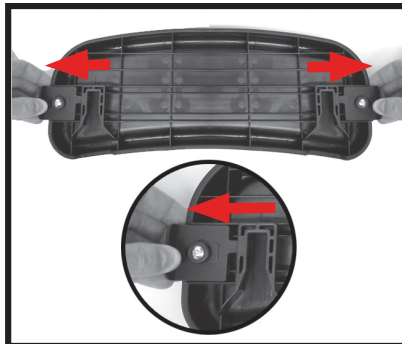

**9** Slide tray and folded feeding chair into carry bag.



## ADULT CHAIR REQUIREMENTS

---

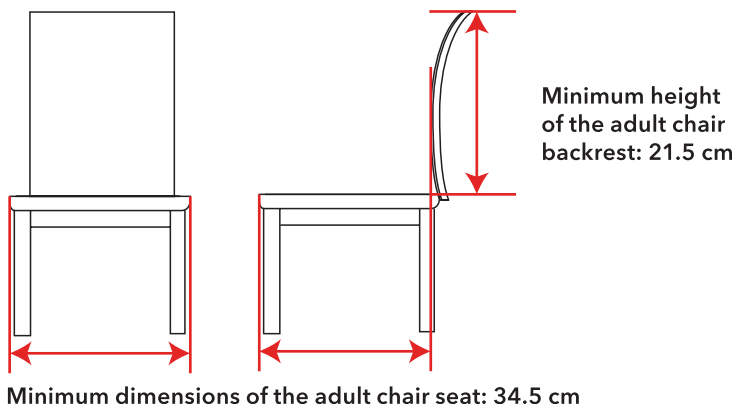

## CARE AND MAINTENANCE

---

- **ALWAYS** check and inspect the feeding chair for damaged hardware, loose joints, missing parts, or sharp edges. **DO NOT** use feeding chair if any parts are missing, torn, or broken.
- To wash feeding chair, fabric cover and chair straps, wipe clean with a damp cloth or sponge using mild soap and clean warm water. Towel or air dry.
- Tray is dishwasher safe, top rack only.

## WARRANTY

---

This product was manufactured by Harmony Juvenile Products® (HJP). HJP warrants this product to the original retail purchaser as follows:

### LIMITED 1-YEAR WARRANTY

This product is warranted against defective materials and workmanship for one year from the date of original purchase. An original receipt is required to validate your warranty. HJP will, at its option, provide replacement parts for this product or replace this product. HJP reserves the right to discontinue or change fabrics, parts, models or products, or to make substitutions.

To make a claim under this warranty, you must contact HJP Customer Service at [www.harmonyjuvenile.com](http://www.harmonyjuvenile.com), or call +44 (0) 1704 549881, or write to 10 Beach Priory Gdns., Southport, UK, PR8 1RT.

Proof of purchase is required and shipping charges are the responsibility of the consumer.

### WARRANTY LIMITATIONS

This warranty does not include damages which arise from negligence, misuse, or use not in accordance with this instruction manual.

### LIMITATIONS OF DAMAGES

The warranty and remedies as set forth above are exclusive and in lieu of all others, oral or written, expressed or implied. In no event will HJP or the retailer selling this product be liable to you for any damages, including incidental or consequential damages, or loss of use arising out of the use or inability to use this product.